

# 钢厂用输送链

## CONVEYOR CHAINS FOR STEEL MILL

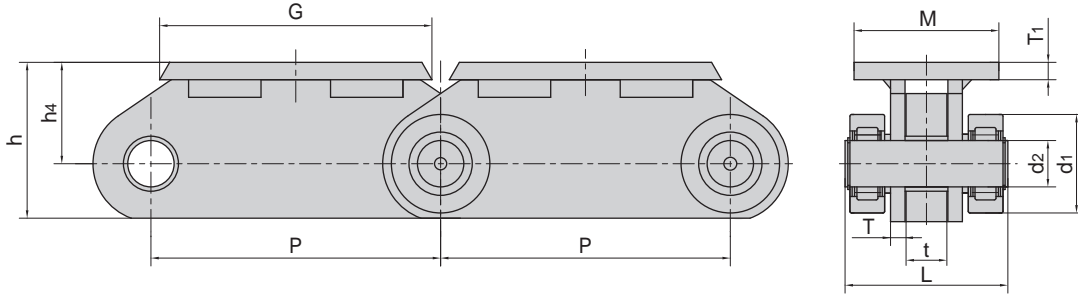

# 钢厂用输送链 Conveyor chains for steel mill



东华链号 Donghua Chain No.	节距 Pitch	滚子直径 Roller diameter	销轴直径 Pin diameter	销轴长度 Pin length	链板厚度 Plate thickness	附板尺寸 Attachment dimensions					极限拉伸载荷 Ultimate tensile strength
	P	d1 max	d2 max	L max	t/T max	G	M	h4	h	T1	Q min
	mm	mm	mm	mm	mm	mm	mm	mm	mm	mm	kN/lbf
P500	500	170	80	281	50/25	470	250	175	269	30	1900/427419

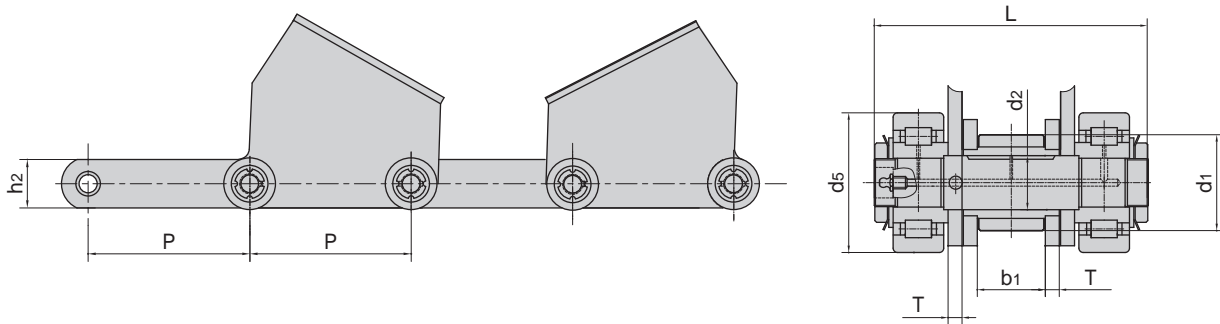

东华链号 Donghua Chain No.	节距 Pitch	滚子直径 Roller diameter		内节内宽 Width between inner plates	销轴直径 Pin diameter	销轴长度 Pin length	链板厚度 Plate thickness	链板高度 Plate depth	极限拉伸载荷 Ultimate tensile strength
	P	d1 max	d5 max	b1 min	d2 max	L max	T max	h2	Q min
	mm	mm	mm	mm	mm	mm	mm	mm	kN/lbf
P500F1	500	107	160	78	62	325	20	150	800/179966
P500F2	500	107	160	76	62	310	16	150	700/157470

# 钢厂用输送链

## Conveyor chains for steel mill

输送链 CONVEYOR CHAINS

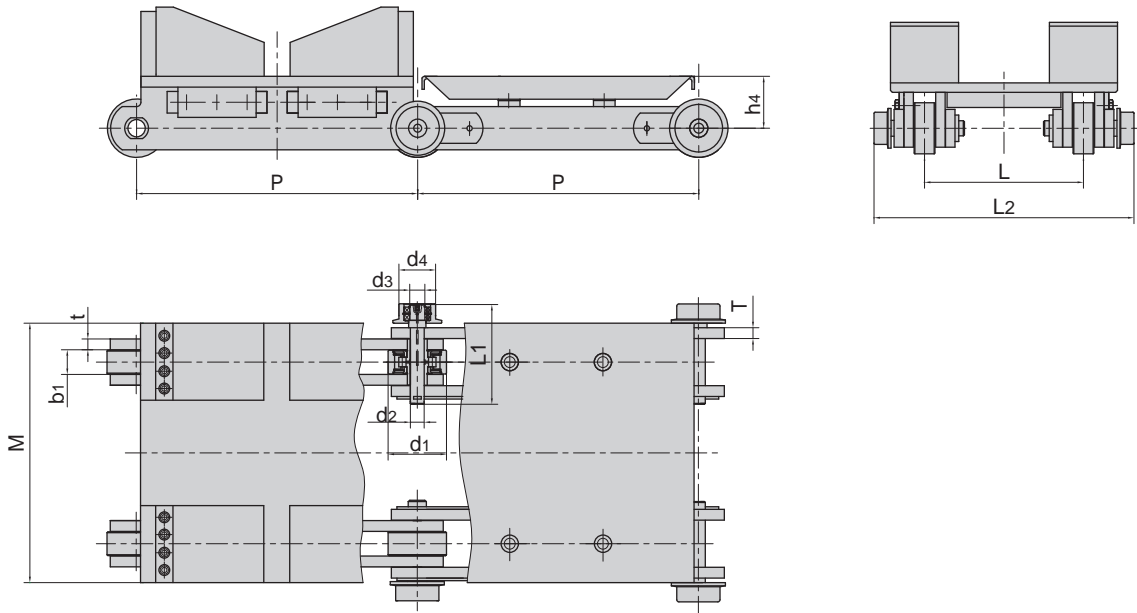

东华链号 Donghua Chain No.	节距	滚子直径		内节内宽	销轴直径		销轴长度	链板厚度	附板尺寸				极限拉伸载荷	每米长重
	Pitch	Roller diameter		Width between inner plates	Pin diameter		Pin length	Plate thickness	Attachment dimension				Ultimate tensile strength	Weight per meter
	P	d1 max	d4 max	b1 min	d2 max	d3 max	L1 max	t/T max	L	L2	M	h4	Q min	q
	mm	mm	mm	mm	mm	mm	mm	mm	mm	mm	mm	mm	kN/lbf	kg/m
P650	650	135	85	56	32	35	232	25	420	690	600	120.0	750/168718	214.5
P750	750	200	85	82	55	35	276	30/25	380	690	600	162.5	2050/460858	-

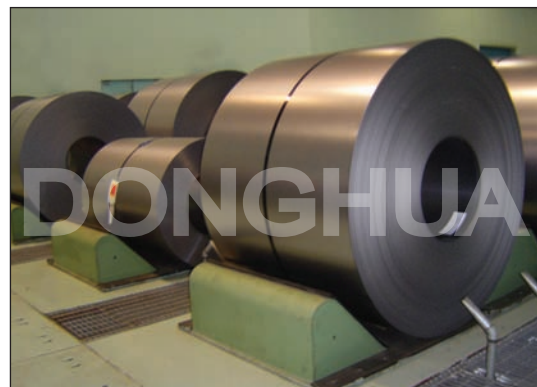

# 钢厂用输送链

## Conveyor chains for steel mill

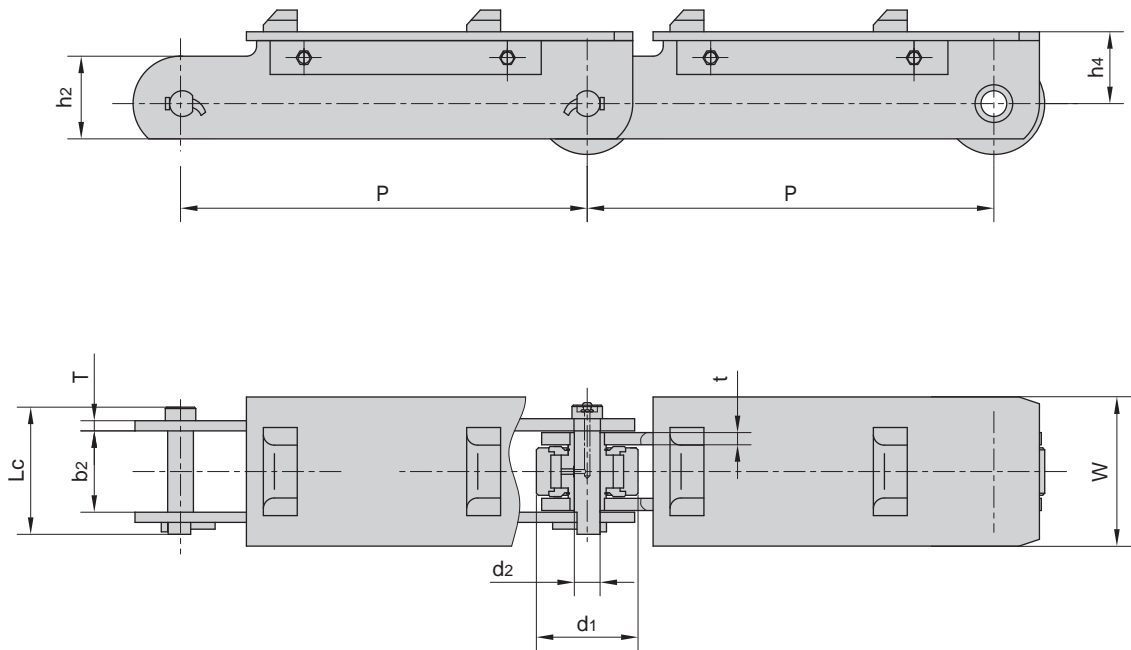

东华链号 Donghua Chain No.	节距	滚子直径	外节内宽	销轴直径	销轴长度	链板高度	链板厚度	附板尺寸		平均拉伸载荷
	Pitch	Roller diameter	Width between outer plates	Pin diameter	Pin length	Plate depth	Plate thickness	Attachment dimension		Average tensile strength
	P	d1 max	b2 min	d2 max	Lc max	h2	t/T max	h4	W	Q <sub>0</sub>
	mm	mm	mm	mm	mm	mm	mm	mm	mm	kN/ bf
P600F1	600	150	117	38	187	122	18/15	105.7	220	1470/330687

# 钢厂用输送链

## Conveyor chains for steel mill

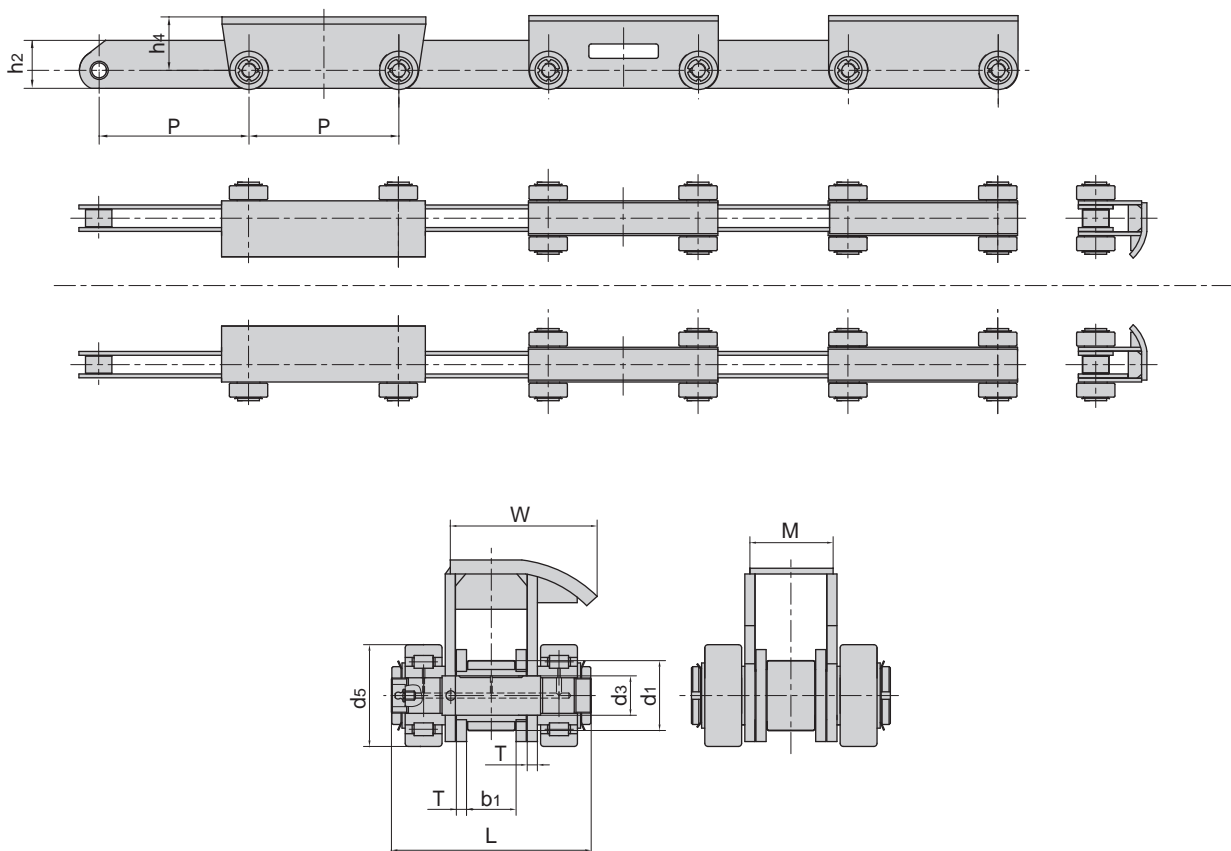

东华链号 Donghua Chain No.	节距	滚子直径		内节内宽	销轴直径	销轴长度	链板厚度	附板尺寸				极限拉伸载荷
	Pitch	Roller diameter		Width between inner plates	Pin diameter	Pin length	Plate thickness	Attachment dimension				Ultimate tensile strength
	P	d1 max	d5 max	b1	d3 max	L max	T max	W	M	h2	h4	Q min
	mm	mm	mm	mm	mm	mm	mm	mm	mm	mm	mm	kN/lbf
P625	625	107	160	78	62	310	16	227.5	130	200	215	700/157470

# 钢厂用输送链

## Conveyor chains for steel mill

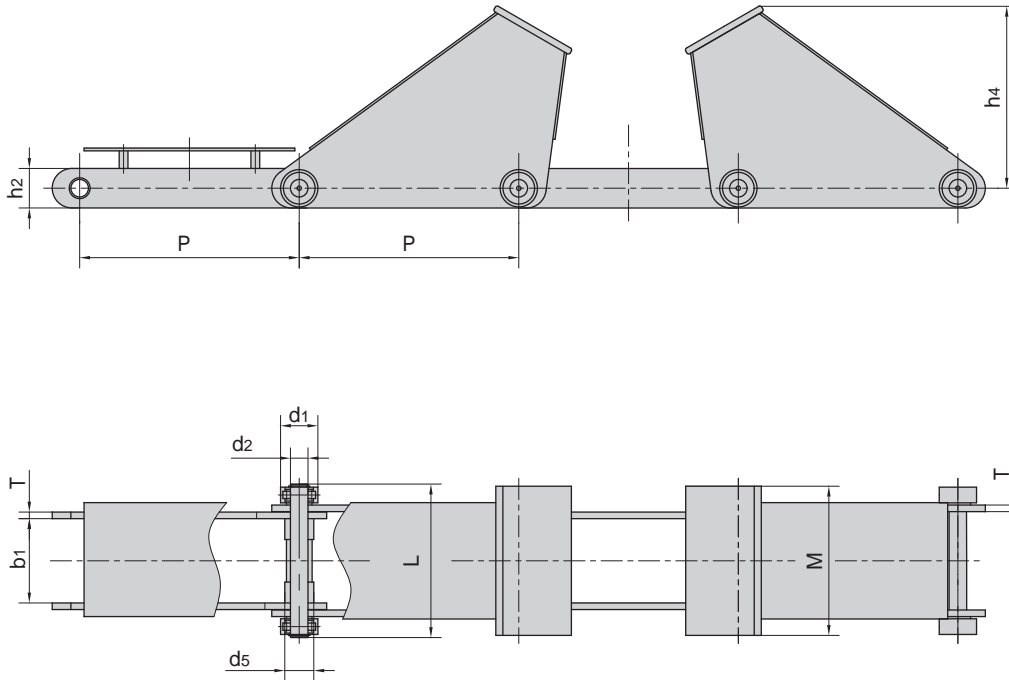

东华链号 Donghua Chain No.	节距	滚子直径		内节内宽	销轴直径	链板高度	销轴长度	链板厚度	附板尺寸		极限拉伸载荷
	Pitch	Roller diameter		Width between inner plates	Pin diameter	Plate depth	Pin length	Plate thickness	Attachment dimension		Ultimate tensile strength
	P	d1 max	d5 max	b1 min	d2 max	h2	L max	T max	h4	M	Q min
	mm	mm	mm	mm	mm	mm	mm	mm	mm	mm	kN/ bf
P1000	1000	170	110	384	80	180	678	30	832	680	1800/404923

# 钢厂用输送链

## Conveyor chains for steel mill

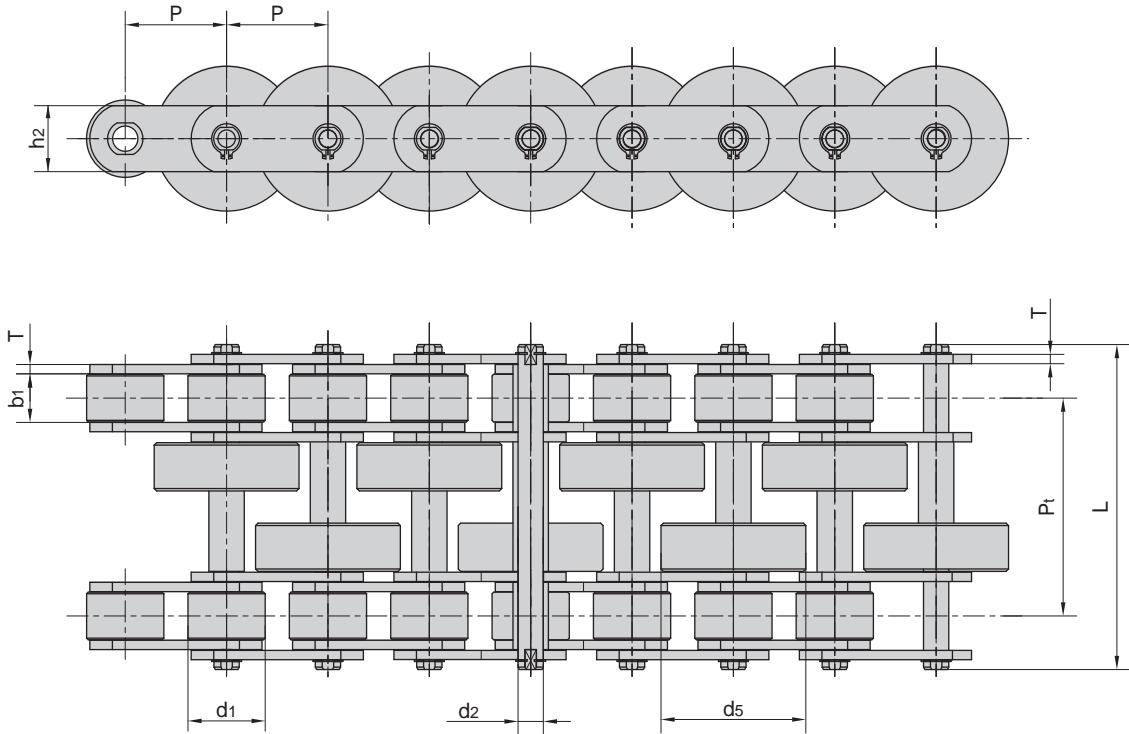

东华链号 Donghua Chain No.	节距	滚子直径		内节内宽	销轴直径	销轴长度	链板厚度	链板高度	排距	极限拉伸载荷	每米长重
	Pitch	Roller diameter		Width between inner plates	Pin diameter	Pin length	Plate thickness	Plate depth	Transverse pitch	Ultimate tensile strength	Weight per meter
	P	d1 max	d5 max	b1 min	d2 max	L max	T max	h2 max	Pt	Q min	q
	mm	mm	mm	mm	mm	mm	mm	mm	mm	kN/bf	kg/m
P63F4	63	48	90	30	15.88	202	6	41	135	200/44991	36.57





# 钢厂用输送链

## Conveyor chains for steel mill

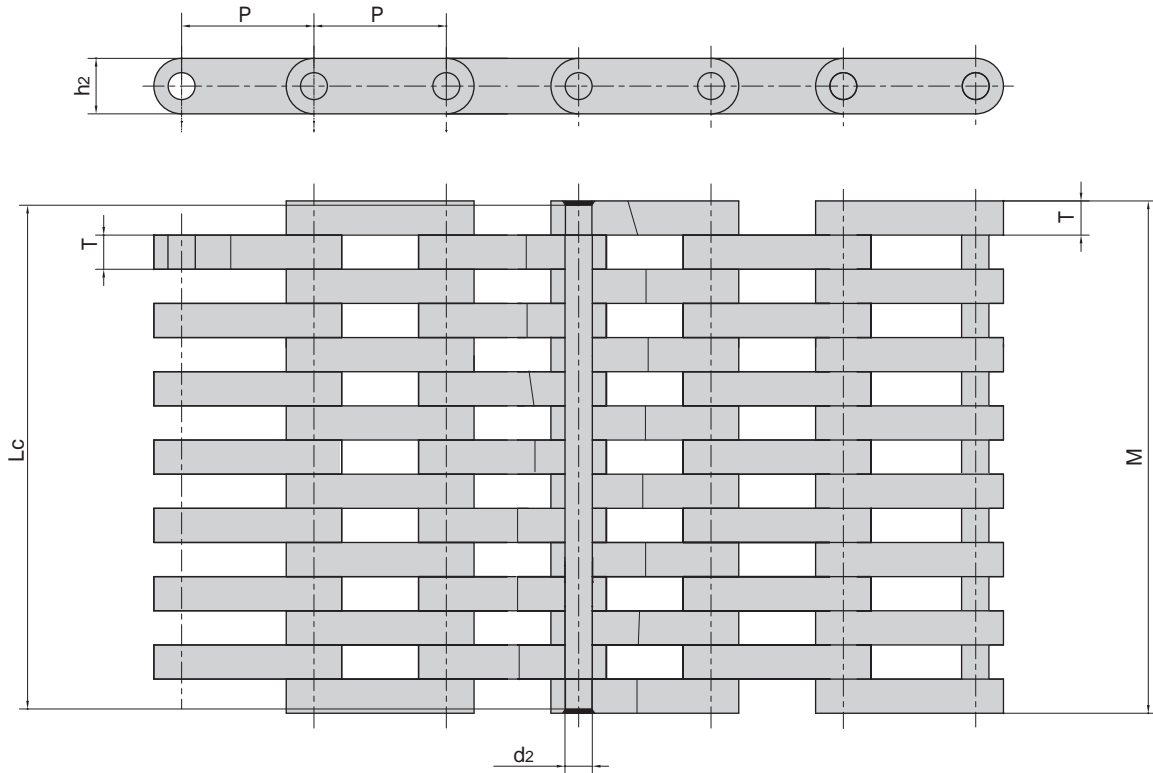

输送链 CONVEYOR CHAINS

东华链号 Donghua Chain No.	节距 Pitch	链板组合 Plate lacing	销轴直径 Pin diameter	销轴长度 Pin length	链板厚度 Plate thickness	链板尺寸 Plate dimension		极限拉伸载荷 Ultimate tensile strength	平均拉伸载荷 Average tensile strength	每米长重 Weight per meter	
	$P$		$d_2$ max	$L_c$ max		$T$ max	$h_2$	$M$	$Q$ min	$Q_0$	$q$
	mm		mm	mm		mm	mm	mm	kN/lbf	kN/ bf	kg/m
LF155	155	7x8	31.5	595	40	65	605	3200/719864	3520/791851	202.2	





# 钢厂用输送链

## Conveyor chains for steel mill

输送链 CONVEYOR CHAINS

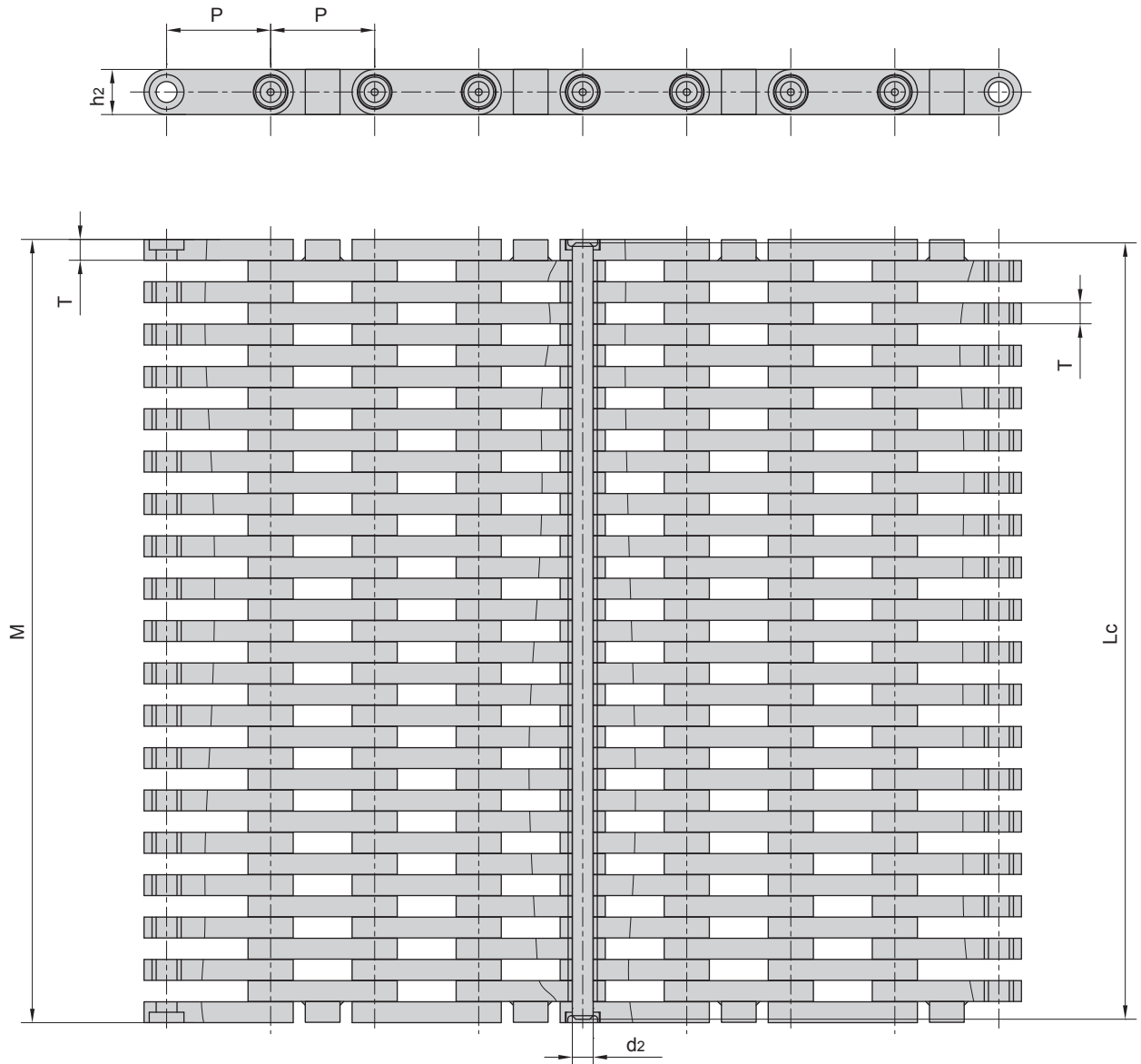

东华链号 Donghua Chain No.	节距	链板组合	销轴直径	销轴长度	链板厚度	链板尺寸		极限拉伸载荷	平均拉伸载荷	每米长重
	Pitch	Plate lacing	Pin diameter	Pin length	Plate thickness	Plate dimension		Ultimate tensile strength	Average tensile strength	Weight per meter
	P		$d_2$ max	$L_c$ max	$T$ max	$h_2$	$M$	$Q_{min}$	$Q_0$	$q$
	mm		mm	mm	mm	mm	mm	kN/bf	kN	kg/m
LF150F1	150	18 x 19	30	1117	30	65	1119	5200/1169000	5700	365

# 钢厂用输送链 Conveyor chains for steel mill

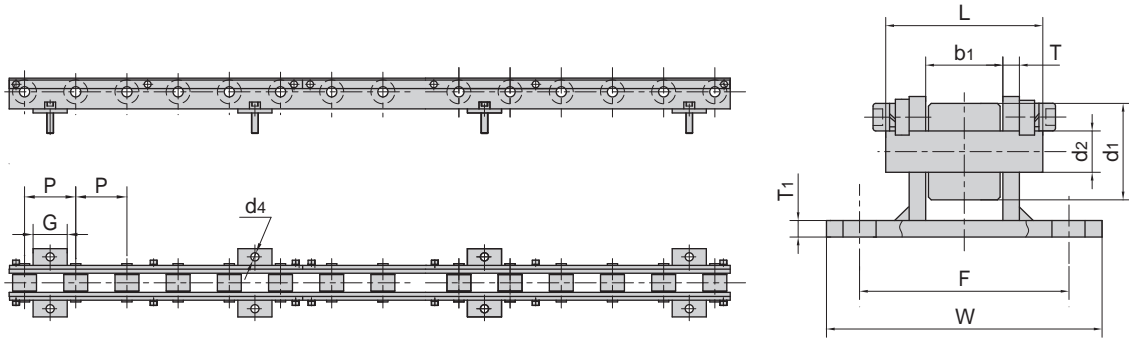

东华链号 Donghua Chain No.	节距 Pitch	滚子直径 Roller diameter	内节内宽 Width between inner plates	销轴直径 Pin diameter	销轴长度 Pin length	链板厚度 Plate thickness	附板尺寸 Attachment dimension					每米长重 Weight per meter
	P	d1 max	b1	d2 max	L max	T max	T1	W	F	d4	G	q
	mm	mm	mm	mm	mm	mm	mm	mm	mm	mm	mm	Kg/m
P75F9	75	35	28	15	56	6	6	100	76	12	75	22.3

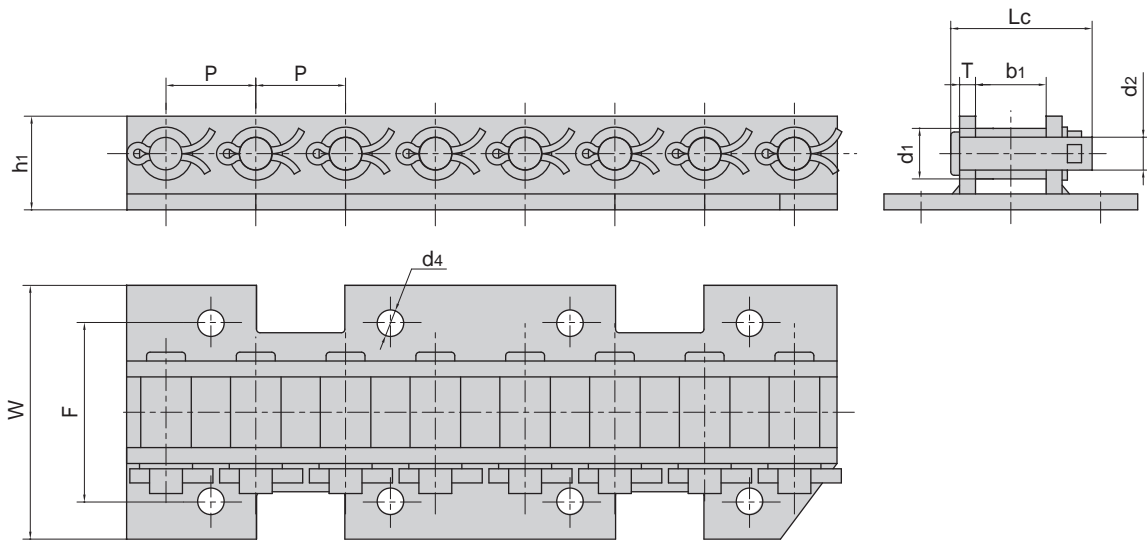

东华链号 Donghua Chain No.	节距 Pitch	滚子直径 Roller diameter	内节内宽 Width between inner plates	销轴直径 Pin diameter	销轴长度 Pin length	链板厚度 Plate thickness	附板尺寸 Attachment dimension					极限拉伸载荷 Ultimate tensile strength	每米长重 Weight per meter
	P	d1 max	b1	d2 max	Lc max	T max	F	W	d4	h1	Q min	q	
	mm	mm	mm	mm	mm	mm	mm	mm	mm	mm	kN/bf	kg/m	
P50.8F10	50.8	28.6	40	18.5	80	9	101.6	143.6	15	53	193/43416	11.2	

# 钢厂用输送链

## Conveyor chains for steel mill

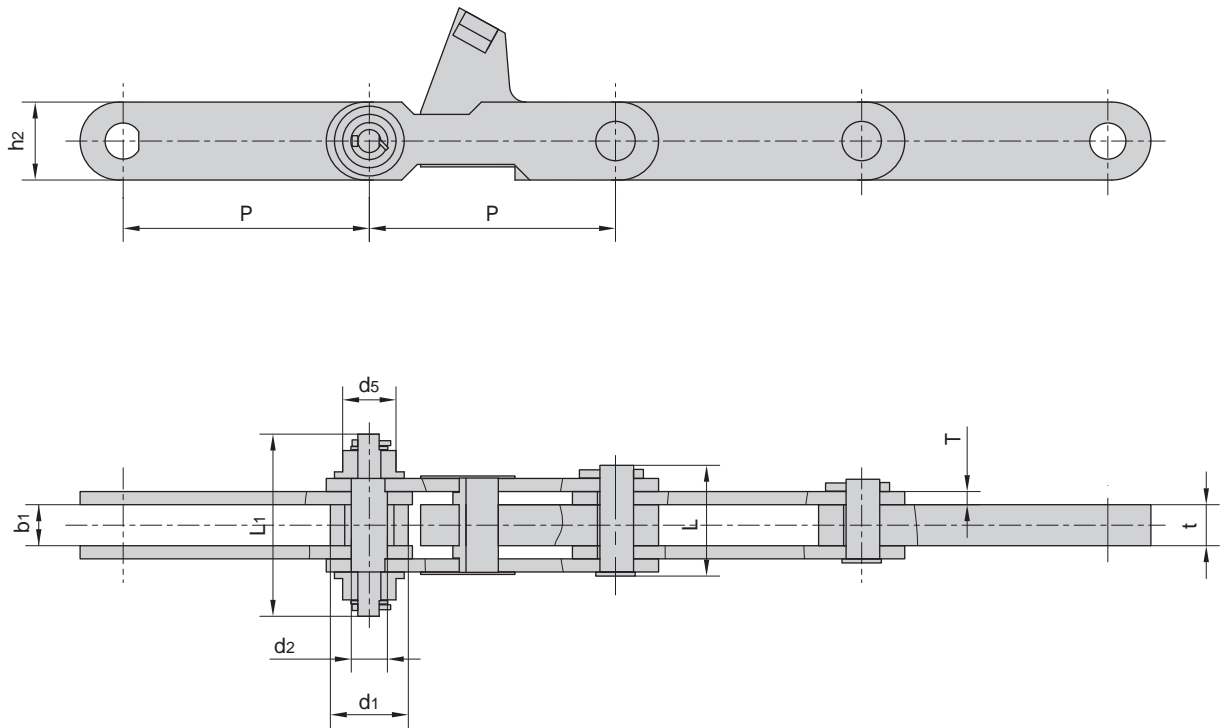

东华链号 Donghua Chain No.	节距 Pitch	滚子直径 Roller diameter		内节内宽 Width between inner plates	销轴直径 Pin diameter	销轴长度 Pin length		链板厚度 Plate thickness	极限拉伸载荷 Ultimate tensile strength
	P	d1 max	d5 max	b1 min	d2 max	L max	L1 max	t/T max	Q min
	mm	mm	mm	mm	mm	mm	mm	mm	kN/lbf
P300F5	300	95	65	50	44	135	222	50/16	500/112478

# 钢厂用输送链

## Conveyor chains for steel mill

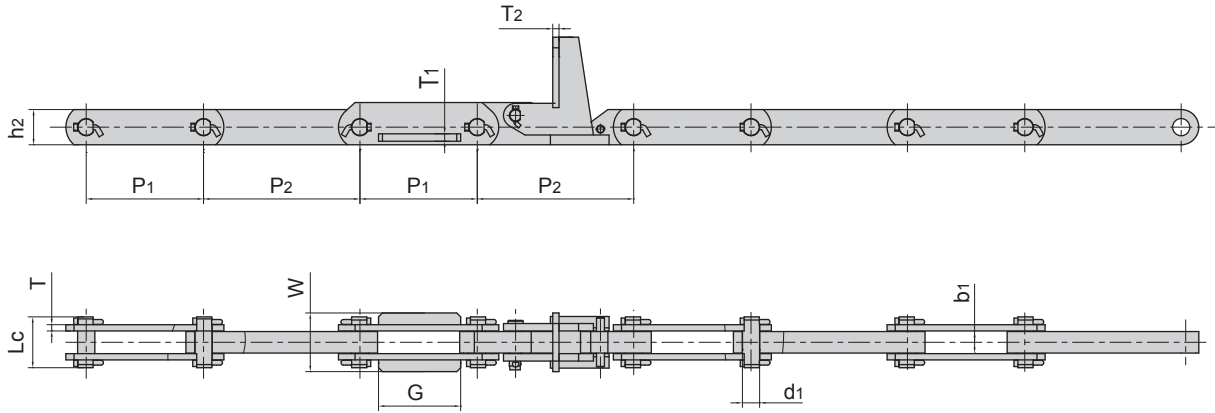

东华链号 Donghua Chain No.	节距 Pitch		外节内宽 Width between outer plates	销轴直径 Pin diameter	销轴长度 Pin length	链板尺寸 Plate dimension		极限拉伸载荷 Ultimate tensile strength	附件尺寸 Attachment dimension			
	P <sub>1</sub>	P <sub>2</sub>				h <sub>2</sub>	T		Q <sub>min</sub>	G	W	T <sub>1</sub>
	mm	mm	b <sub>1</sub> min	d <sub>2</sub> max	L <sub>c</sub> max			mm				
BC300/400F1	300	400	58	42	130	90	16	1270/285500	210	150	19	16

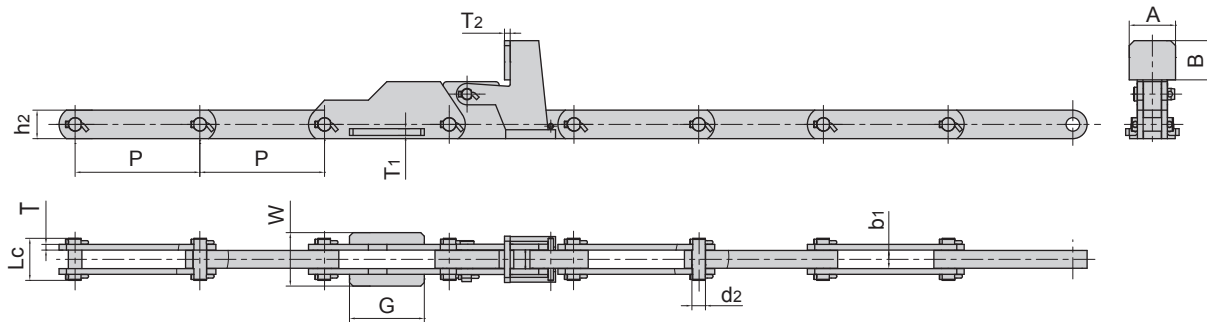

东华链号 Donghua Chain No.	节距 Pitch	外节内宽 Width between outer plates	销轴直径 Pin diameter	销轴长度 Pin length	链板尺寸 Plate dimension		极限拉伸载荷 Ultimate tensile strength	附件尺寸 Attachment dimension					
					h <sub>2</sub>	T		Q <sub>min</sub>	G	W	T <sub>1</sub>	T <sub>2</sub>	A
	P	b <sub>1</sub> min	d <sub>2</sub> max	L <sub>c</sub> max			mm						
BC350F1	350	53	38	118	80	16	1080/242793	210	150	19	16	130	110

# 钢厂用输送链

## Conveyor chains for steel mill

输送链 CONVEYOR CHAINS

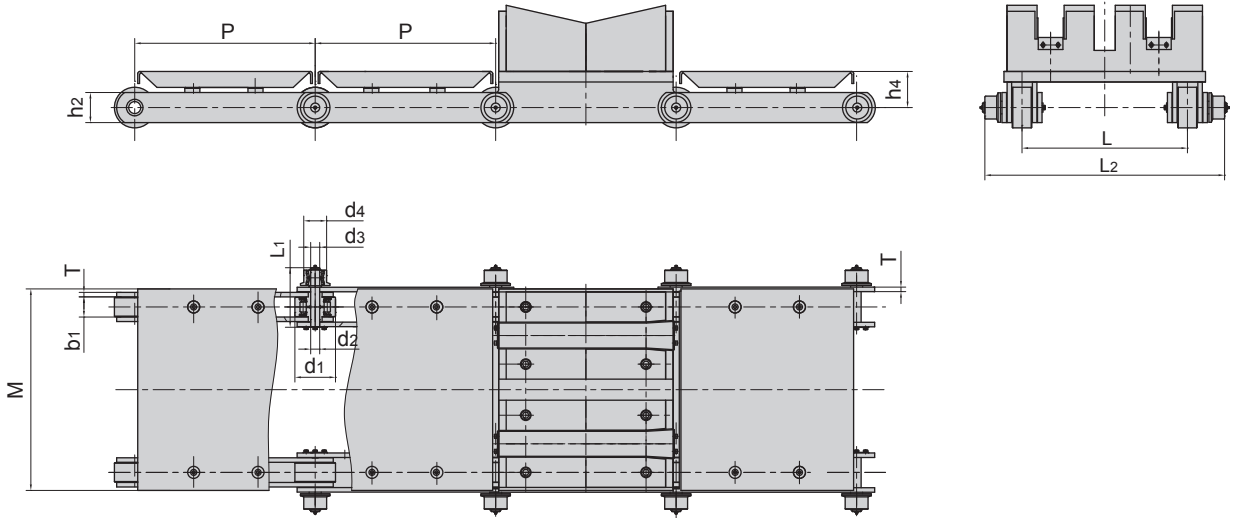

东华链号 Donghua Chain No.	节距 Pitch	滚子直径 Roller diameter		内节内宽 Width between inner plates	销轴直径 Pin diameter		销轴长度 Pin length	链板尺寸 Plate dimension		附件尺寸 Attachment dimension				极限拉伸载荷 Ultimate tensile strength
	P	d1 max	d5	b1 min	d2 max	d3 max	Lc max	h2	T max	L	L2	M	h4	Q min
	mm	mm	mm	mm	mm	mm	mm	mm	mm	mm	mm	mm	mm	kN/lbf
P600F3	600	135	76	68	30	30	200.3	100	15	550	794	670	120	1000/224809

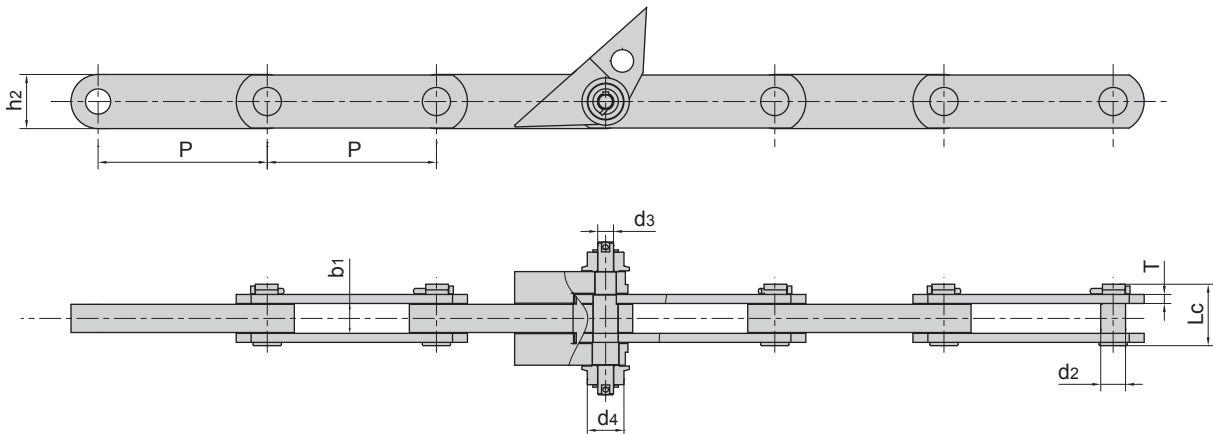

东华链号 Donghua Chain No.	节距 Pitch	滚子直径 Roller diameter	外节内宽 Width between outer plates	销轴直径 Pin diameter		销轴长度 Pin length	链板尺寸 Plate dimension		极限拉伸载荷 Ultimate tensile strength
	P	d4 max	b1	d2 max	d3 max	Lc max	h2	T max	Q min
	mm	mm	mm	mm	mm	mm	mm	mm	kN/lbf
P300F7	300	65	53	44	28	108.9	96	16	500/112404